

Excel Mouse Pointers

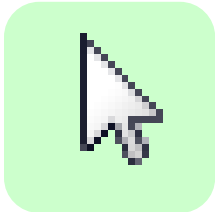

Standard

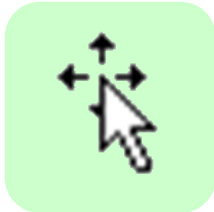

Move

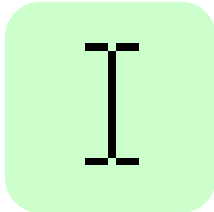

Text ("i-beam")

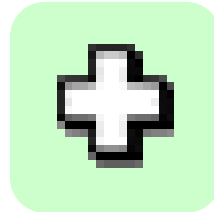

Selection ("box cross")

Click and drag to select multiple cells.

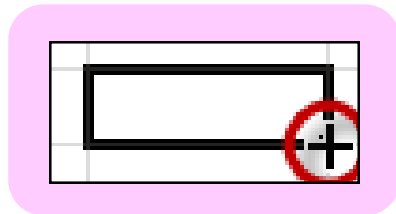

Fill

Mouse pointer changes to a "cross" when close to fill handle. Click and drag to Fill adjacent cells.

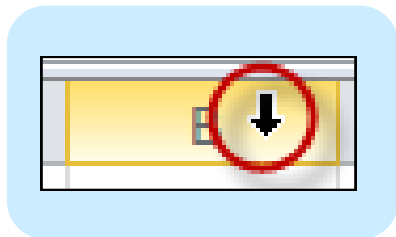

Select Column

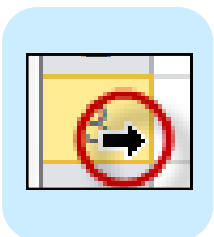

Select Row

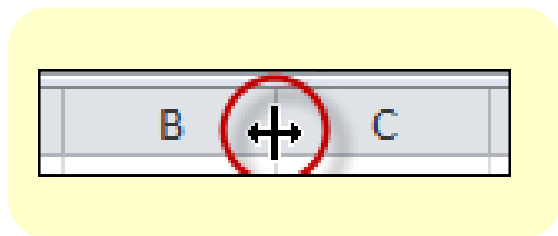

Column Width

Double click to resize.

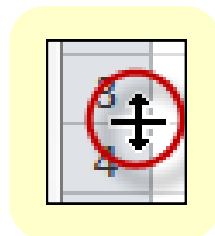

Row Height

Double click to resize.